

INSTALLATION AND SERVICE MANUAL



For Installation of Gini wall surface luminaire LED

Model. UGN-30041,UGN-30051,UGN-30061,UGN-30071,UGN-30081 and UGN-30091

Product drawing (dimensions) SUITABLE FOR WET LOCATIONS

One side

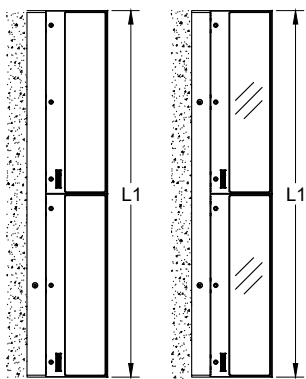

Top view Bottom view

Two side

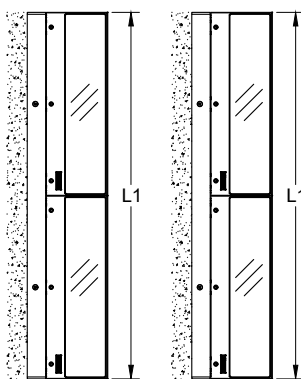

Top view Bottom view

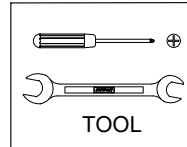

TOOL

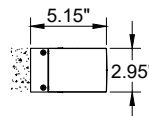

Model No.	Dimension				
	L1	D1	D2	D3	D4
UGN-30041	23.46"	23.30"	23.30"	7.08"	7.08"
UGN-30061	35.19"	34.84"	30.90"	9.84"	11.22"
UGN-30081	46.92"	46.45"	44.88"	9.05"	8.66"

Model No.	Dimension				
	L1	D1	D2	D3	D4
UGN-30051	23.46"	23.30"	23.30"	7.08"	7.08"
UGN-30071	35.19"	34.84"	30.90"	9.84"	11.22"
UGN-30091	46.92"	46.45"	44.88"	9.05"	8.66"

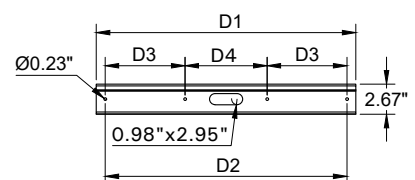

MOUNTING DETAIL

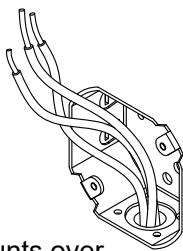

①

NOTE Mounts over a 3" Octagonal Junction box.

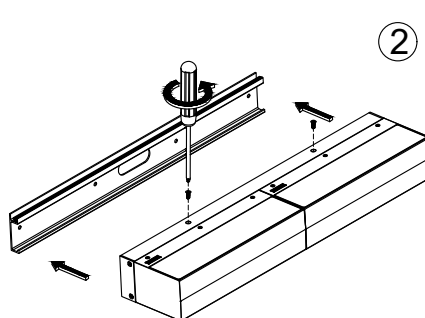

②

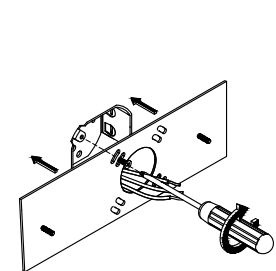

③

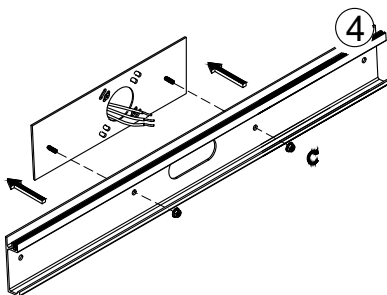

④

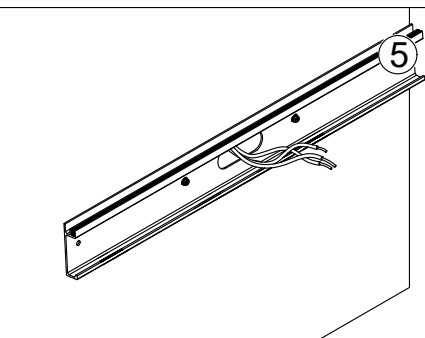

⑤

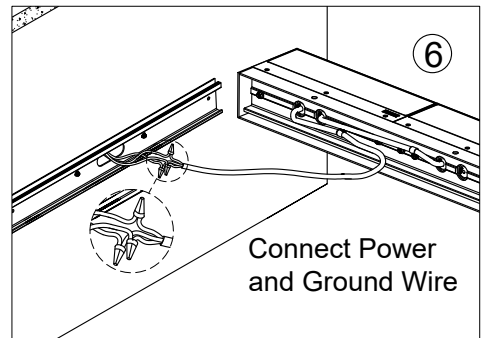

⑥

Connect Power and Ground Wire

Notice to installer :

- 1.WIRING INSTRUCTIONS** Warning : RISK OF FIRE AND ELECTRICAL SHOCK. : FIXTURE MUST BE INSTALLED BY A QUALIFIED ELECTRICIAN ONLY>FIXTURE IS INTENDED FOR INSTALLATION IN ACCORDANCE WITH THE NATIONAL ELECTRICAL CODE, LOCAL AND FEDERAL CODE SPECIFICATIONS. DISCONNECT POWER BEFORE SERVICING.
- 2.This fixture has a VOLTAGE SPECIFIC BALLAST,**Check that the supply voltage is the same as the installed ballast voltage.

Ligman Lighting USA

7144 NE Progress Court, Hillsboro
Oregon, 97124, USA
Tel : 503 645 0500 | Fax : 503 645 8100

www.ligmanlightingusa.com

UGN-30041 04/03/24 REV.0
1/2

FM-TS-13-1/13-05-2563/Rev.6

